

AMARA 900 DOUBLE DRAWER FLOOR VANITY



PRODUCT CODES & FINISHES



Ultra Gloss White
FRONT PANELS ONLY



Ultra Touch
Matt Black



Ultra Touch
Matt Tungsten



Ultra Touch
Matt White



Baroque



Ranfury
Oak



Hickory
Walnut



Blackened
Elm



Rural
Oak



Indian
Ink



Perfect
White



Friar
Grey



Green
Slate



Triple
Duck Egg



Tusk / Quarter
Napa



Anthracite



Nordic
Ash



Borders
Oak



Charred
Oak

CABINERY

| | |
|----------------------|--------------------------|
| INSTALLATION | Floor standing |
| CONFIGURATION | 2 soft close drawers |
| MATERIAL | Moisture resistant board |
| WIDTH (mm) | 890 |
| DEPTH (mm) | 452 |
| HEIGHT (mm) | 830 |
| ORIGIN | Aotearoa / New Zealand |

VANITY TOP

| | |
|-----------------------|---------------------------------|
| FINISH | Gloss white |
| MATERIAL | Composite |
| TAP HOLE | Yes |
| OVERFLOW | No |
| WASTE SIZE | Suits 32mm and 40mm waste traps |
| WASTE INCLUDED | No |
| WIDTH (mm) | 900 |
| DEPTH (mm) | 452 |
| ORIGIN | PRC |

AVAILABLE EXCLUSIVELY AT



GENERIC CODES FOR MERCHANT USE ONLY

| | |
|--------------------|-----------|
| GLOSS WHITE | 5AMA090DG |
| COLOUR | 5AMA090DC |
| ULTRA TOUCH | 5AMA090DE |

NOTES

- 5 year warranty*
- Cabinets made from moisture resistant board with PUR bonding technology, sustainably sourced from FSC certified NZ Radiata Pine
- Optional - Pop-up waste available**

AUGUST 2024

ALL MEASUREMENTS ARE NOMINAL
 *WARRANTIES APPLY TO RESIDENTIAL DOMESTIC USE ONLY. WARRANTY VOID
 IF PRODUCT IS NOT INSTALLED ACCORDING TO OUR SPECIFICATIONS.
 **FOR FURTHER INFORMATION ON BIPR, INSTALLATION GUIDE AND PRODUCT
 OPTIONS PLEASE REFER TO THE WEBSITE.
athena.co.nz

AMARA 900 DOUBLE DRAWER FLOOR VANITY

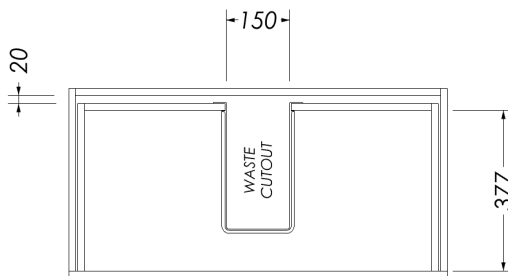
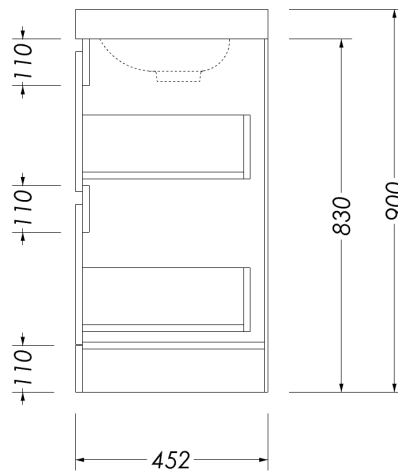
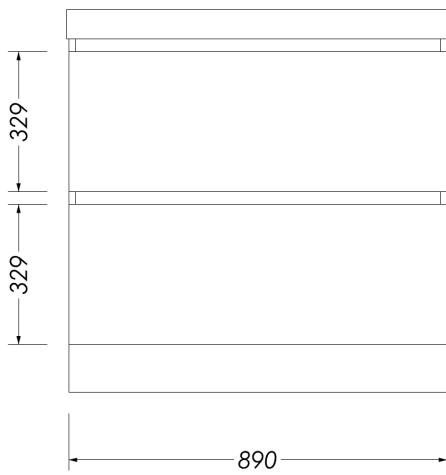
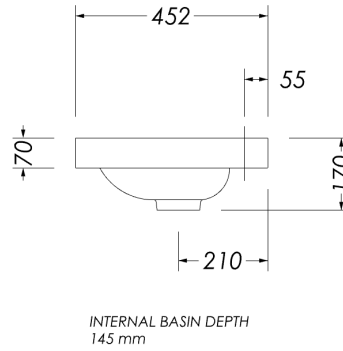
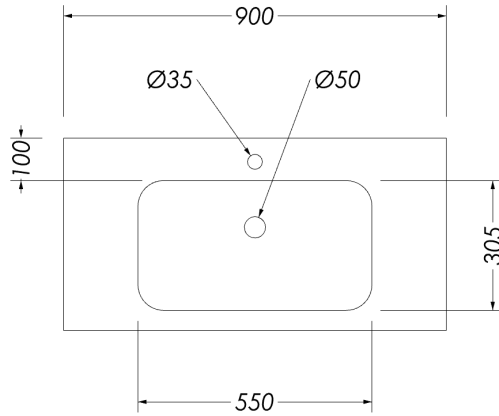

TOP & BOTTOM DRAWER CROSS SECTION

AUGUST 2024

ALL MEASUREMENTS ARE NOMINAL
 *WARRANTIES APPLY TO RESIDENTIAL DOMESTIC USE ONLY. WARRANTY VOID
 IF PRODUCT IS NOT INSTALLED ACCORDING TO OUR SPECIFICATIONS.
 **FOR FURTHER INFORMATION ON BIFR, INSTALLATION GUIDE AND PRODUCT
 OPTIONS PLEASE REFER TO THE WEBSITE.
athena.co.nz