

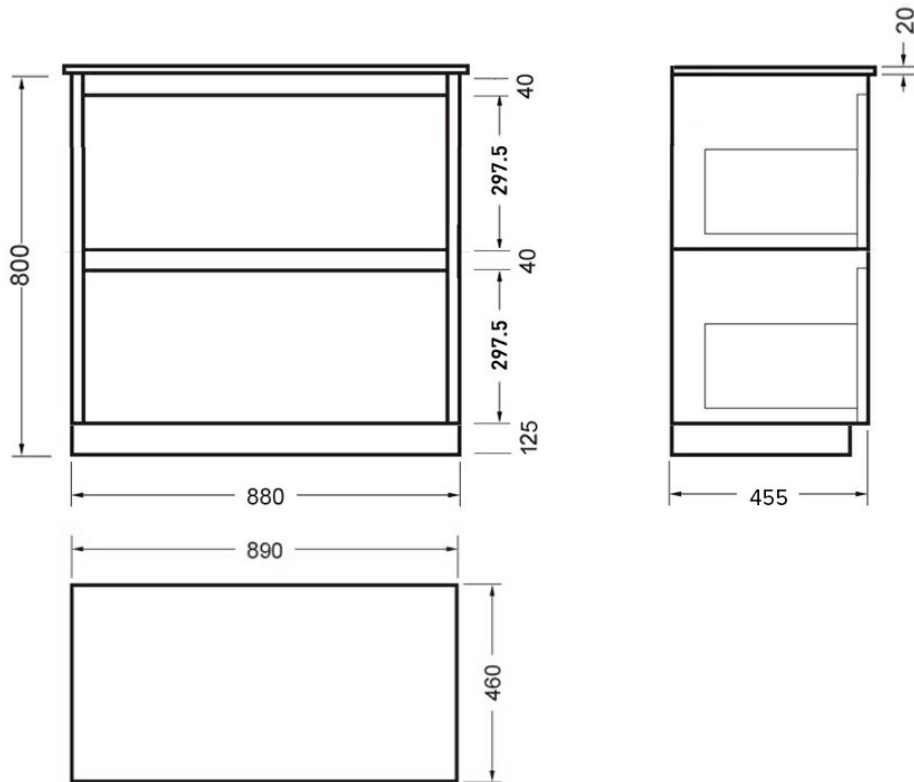

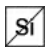



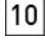

NOVARA FLOOR VANITY 900 2 X DRAWER  
ELESTONE TOP

87233Exx.xx

ELEMENTI



	<b>Silica Free</b>	No use of Silica on vanity tops making it safer for you & the family
	<b>Residential/Light Commercial Use</b>	Suitable for Residential/Light Commercial Use (Kitchens, Bathrooms and Laundries in Hotels, Motels and Retirement Villages).
	<b>Guarantee</b>	5 Year Guarantee
	<b>Guarantee</b>	10 Year Guarantee on EleStone Top
	<b>Hafele Lifetime Warranty</b>	All Hafele Hardware comes with a Lifetime Warranty.
	<b>Moisture Resistant</b>	Made from Moisture Resistant Board
	<b>Soft Close Drawer System</b>	Incorporates Soft Close Drawer and Doors.
	<b>Environmental Choice</b>	Product manufactured predominantly from sustainably grown New Zealand plantation pine forests and is Environmental Choice Certified.
	<b>Made in New Zealand</b>	Designed & Engineered in New Zealand



Crisp lines, a clean finish and impressive features; a stylish and practical option for any space, our Elementi Novara bathroom vanities are available in 12 cabinet finishes with various top options to suit even the most particular of tastes.